



This tutorial explains how to edit cut paths in the Product Editor.

Download the Asanti Sample Files via the Asanti Client (Help > Asanti Online > Download Sample Files).

## 1. Create new cut paths

1. File>New Wide Format Job.
2. Select a printer.
3. Set sheet size to e.g. 1000x700 mm.
4. Open the Finishing inspector.
5. Select Cutter "Zünd" and select Finishing Margins "iCut Corner Marks, between 10".
6. Add "ASANTI Visual 390x250.pdf" file from the Sample Files.
7. Double click the product to open the Product Editor.
8. In the 'Cut Path Editor'  select the 'Rectangle Tool'  and draw a rectangle to include the 'cube' and the word 'ASANTI'.

A new path is created and automatically assigned to the default Operation. Assign it to the 'Through Cut' Operation when another default Operation was assigned.

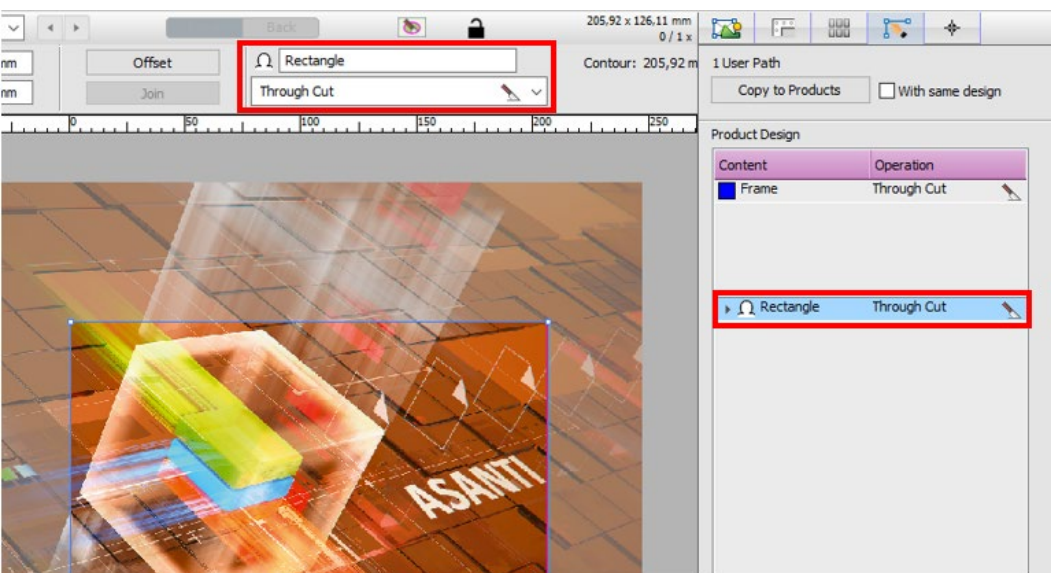
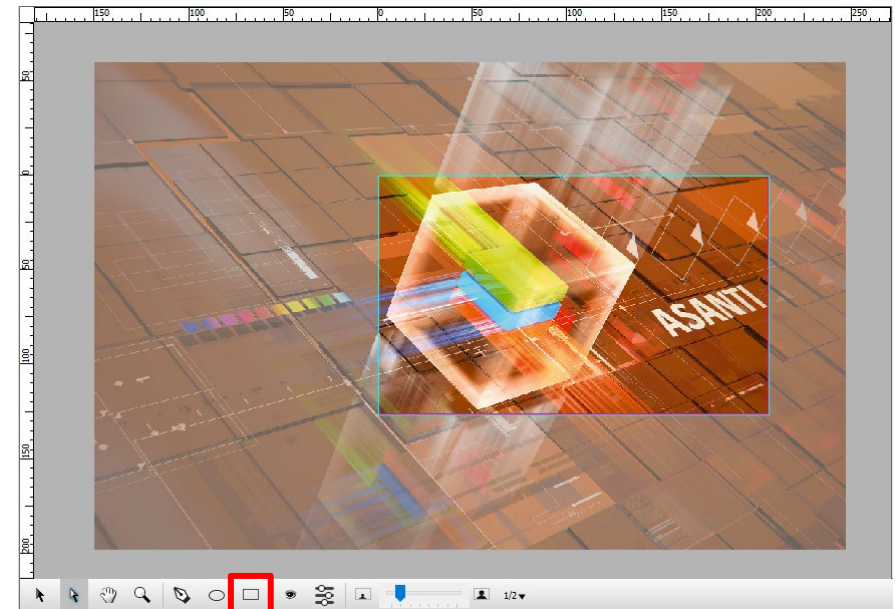
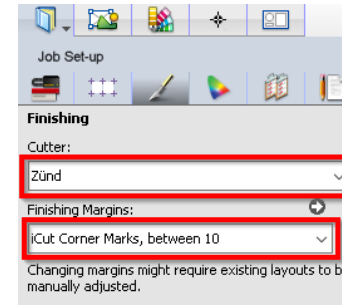

9. Select the 'Ellipse Tool' , press the 'Shift-key' and draw a large circle inside the rectangle.

A new path is created and automatically assigned to the default Finishing Operation. Change the name to 'Circle' in the position bar and assign it to the 'Kiss' Operation.

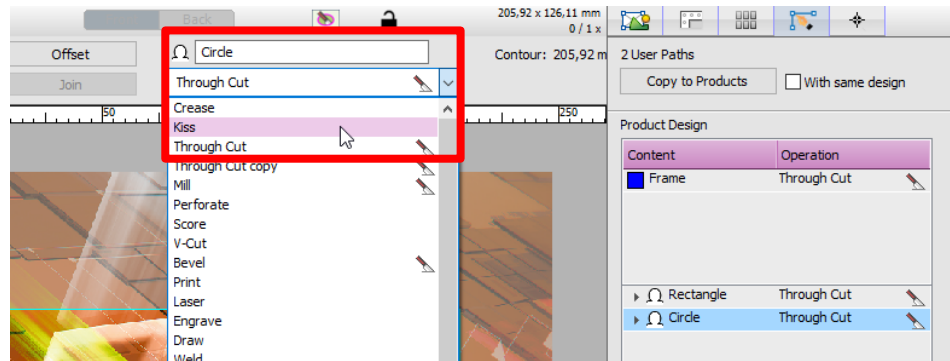

10. With the 'Path Selection Tool'  move the Circle in order to encircle the word 'ASANTI' and you can adjust the size by dragging the handles in the corners with the Shift key pressed.

11. Select the 'Pen Tool' .

- Start drawing a custom shape around the 'cube'. A mouse click will create a new point, click and drag will provide handles to create smooth Bezier curves. Press the 'Alt-key' to change the direction of the Bezier.
- Finalize the path by mouse click on start point (=> close path) or click 'Esc' (=> open path).
- Change the name to 'CustomShape' in the position bar.
- Assign this new path to the 'Kiss' Finishing Operation.

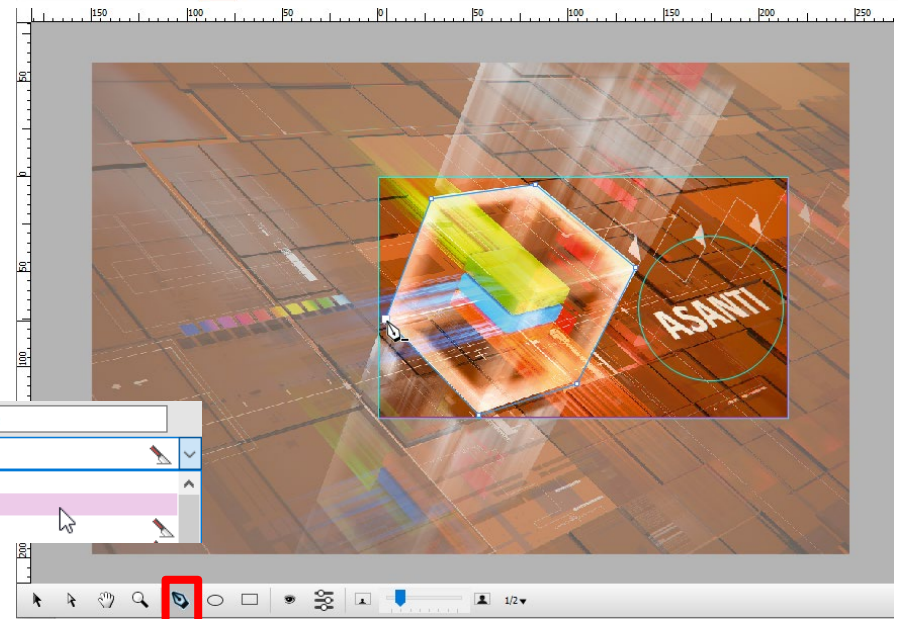
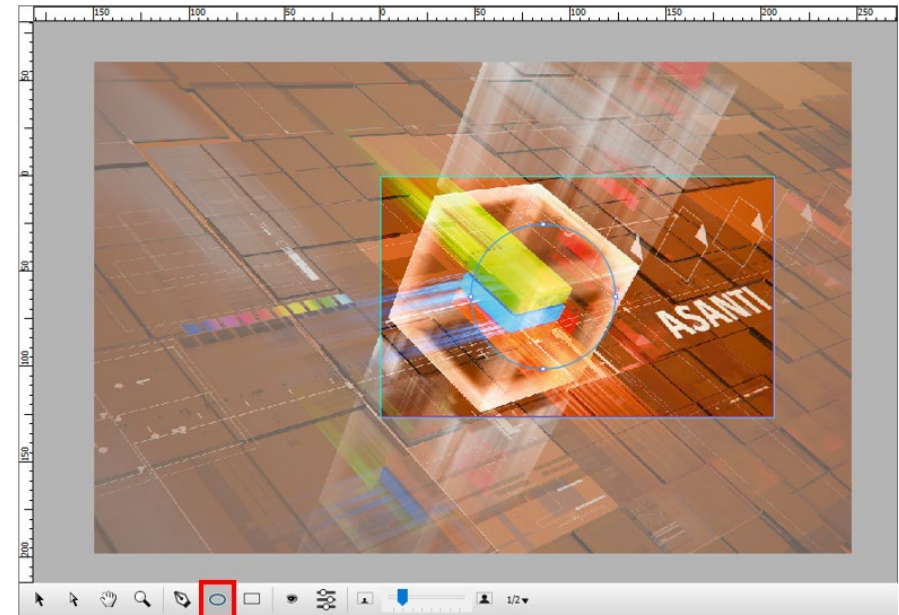

*To adjust the control points, you first have to finalize the path and then use the 'Point Selection Tool' .*

12. In order to only use the new created paths, select the 'Frame (Through Cut)' path and context click to 'Delete' (or Delete key).
13. 'Apply' these changes and drag the product to the sheet.
  - The image contour is now clipped to the rectangle path.

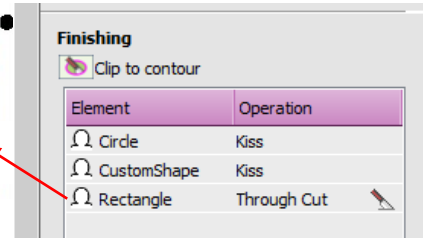
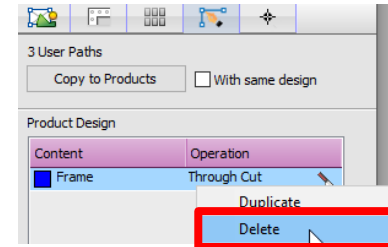

- In the Frame/Product inspector you can select and preview all new created paths.

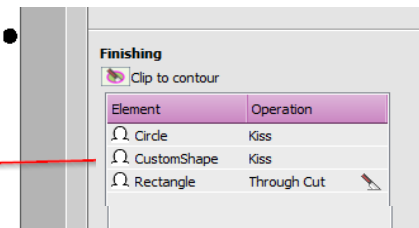

14. Submit Job > Change the job name to 'Create new cut paths' > "Make and hold" for Print Files and "Make and send to cutter" for Cut Files.
15. In the job list, context click on the new job and choose 'Reveal Cut File for Job' and open the created cut file.

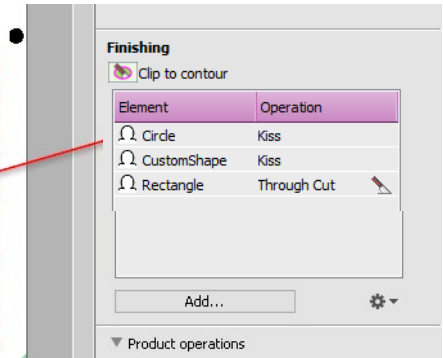

- You can see the new created paths in the correct layers

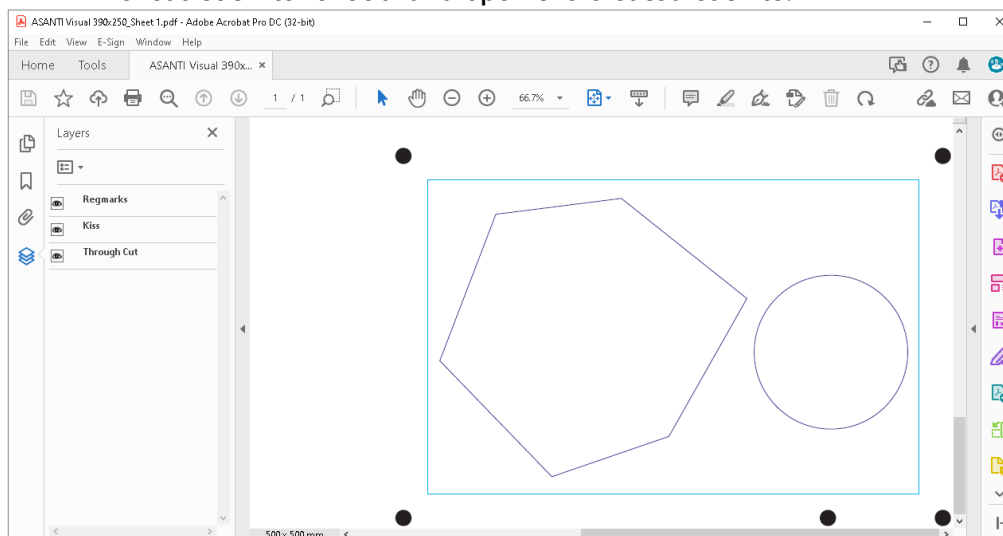

## 2. Adjust existing cut paths

1. File>New Wide Format Job.
2. Select a printer.
3. Set sheet size to e.g. 1000x700 mm.
4. Open the Finishing inspector.
5. Select Cutter “Zünd” and select Finishing Margins “iCut Corner Marks, between 10”.
6. Add “Circle of Asanti.pdf” file from the Sample Files.
7. Double click the product to open the Product Editor.
8. In the ‘Cut Path Editor’ , add a new assignment from ‘Content Element: Through Cut’ to ‘Operation: Kiss’.
9. Select the ‘Through Cut (Kiss)’ path and click the ‘Offset’ button. Enter ‘-10 mm’ and enable ‘Preview’ to verify this ‘inset’.
10. Click OK and ‘Apply’ these changes in the Product Editor.
11. Drag the product to the sheet.

In the Frame/Product inspector you can see that:

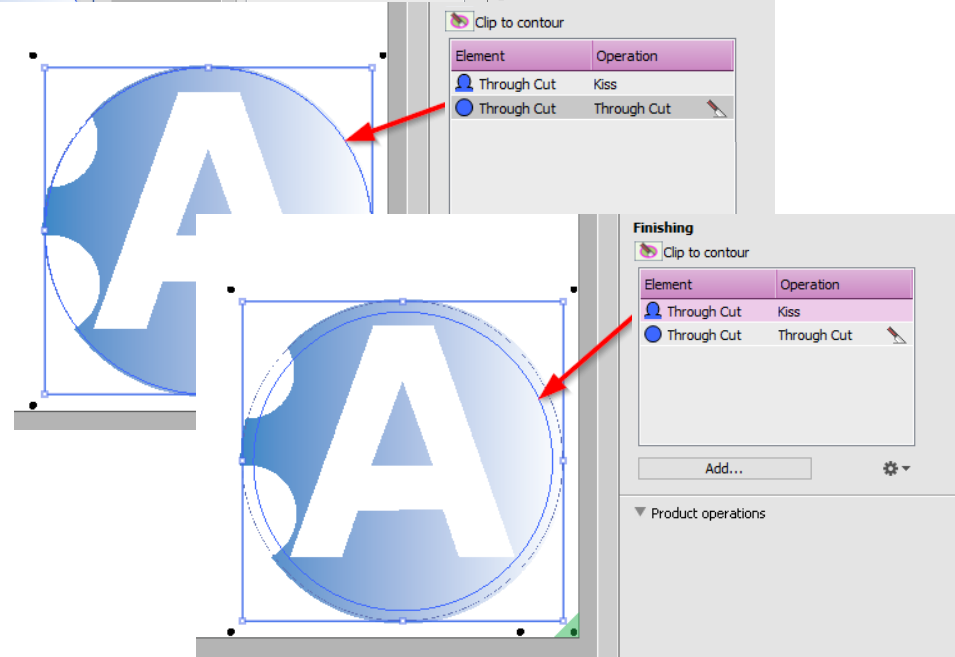
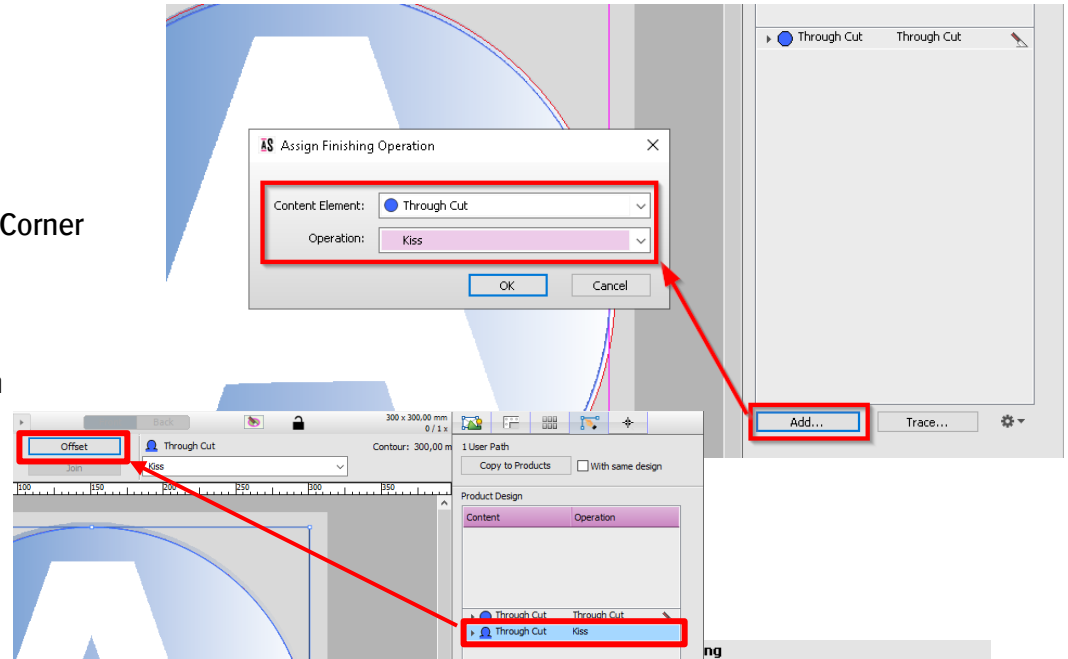
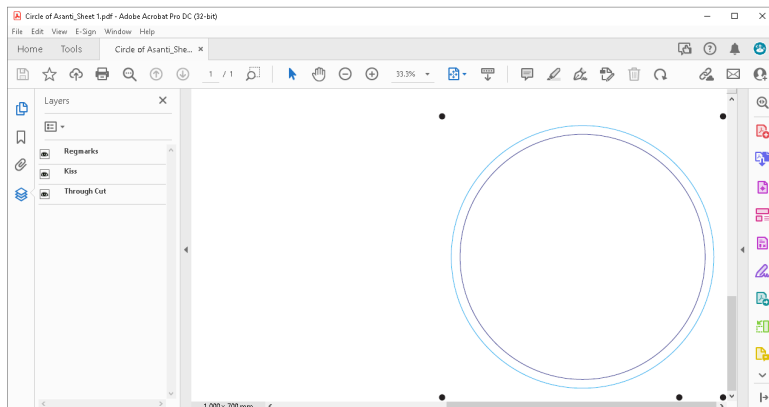

- The image contour is still clipped to the original Through Cut path
- The path for the ‘Kiss’ operation is inset.

12. Submit Job > Change the job name to ‘Adjust existing cut paths’ > “Make and hold” for Print Files and “Make and send to cutter” for Cut Files.
13. In the job list, context click on the new job and choose ‘Reveal Cut File for Job’ to open the cut file.



- You can see the new created paths in the correct layers

### 3. Trace to create a contour cut path

1. File>New Wide Format Job.
  2. Select a printer.
  3. Set sheet size to e.g. 1000x700 mm.
  4. Open the Finishing inspector.
  5. Select Cutter “Zünd” and select Finishing Margins “iCut Corner Marks, between 10”.
  6. Add “Leeuw-4-USM.jpg” file from the Sample Files.
  7. Double click the product to open the Product Editor.
  8. In the ‘Cut Path Editor’ , click the ‘Trace’ button, set the ‘Edge Contrast’ to ‘Soft’ (0) and click OK. New paths are created, combined into a ‘Trace’ path which is automatically assigned to the default Operation.
- Expand the ‘Trace’ path to see all created ‘paths’. Select the ‘Point Selection Tool’  and select each path one by one. You will see that some of these paths are created in small shadow parts outside the main path. It is safe to delete these paths with context click > ‘Delete’ (or Delete key).
  - In the main path, you can see that the shadows on the claws and mane of the lion are detected as well.

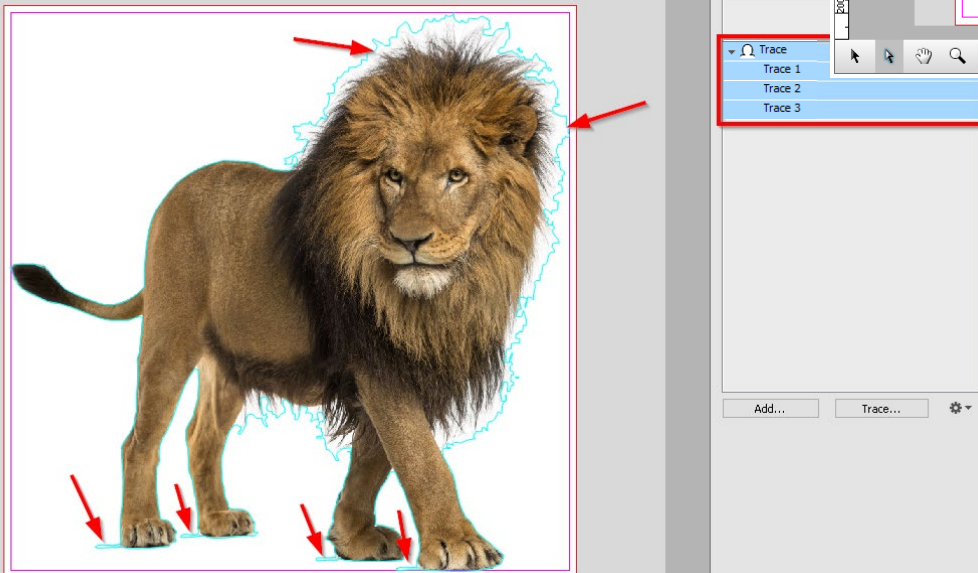
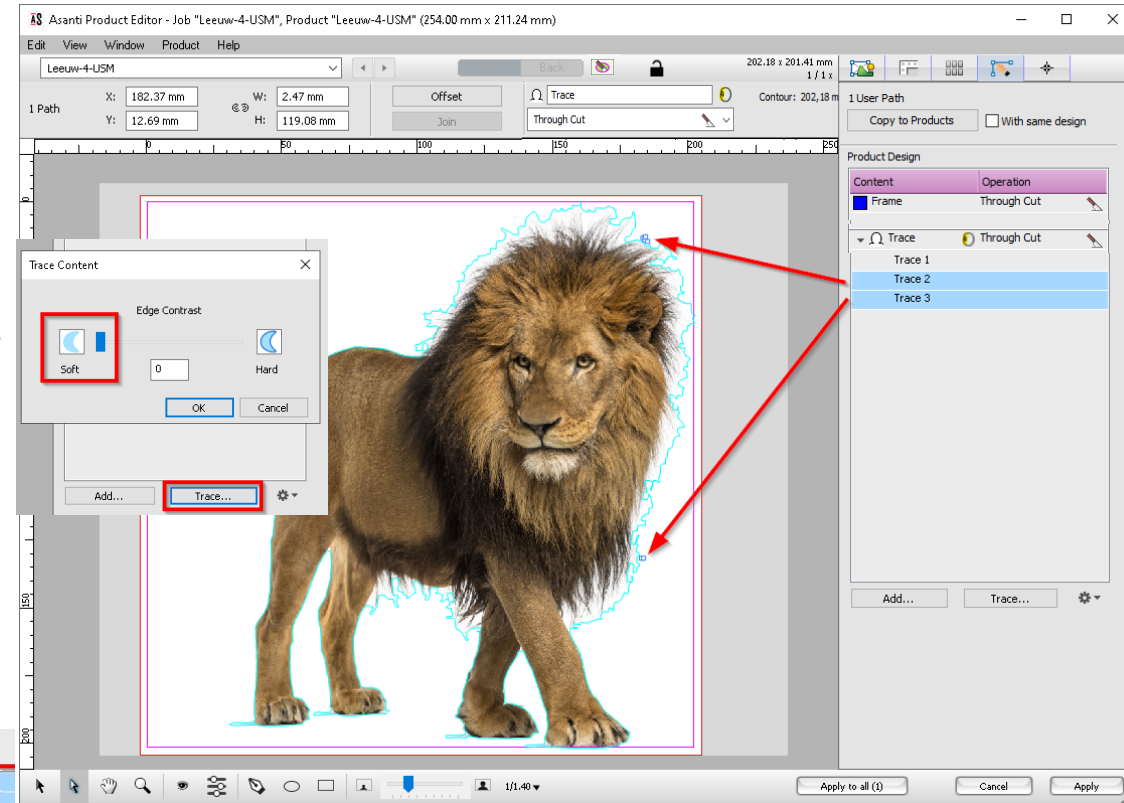

- This tracing is too ‘Soft’

9. Delete the 'Trace' path (Delete key) and click the 'Trace' button again. Set the 'Edge Contrast' to 'Hard' (255) and click OK.

- You can see that the shadows on the claws and mane of the lion are not detected anymore.
- Expand the 'Trace' path to see all created 'paths'. There are 29 paths, none of them is a main path, and many of these 'paths' are inside the lion.

• This tracing is too 'Hard'

10. Undo this 'Trace' (Ctrl+Z) and click the 'Trace' button again. Leave the 'Edge Contrast' to the default (30) and click OK.

- You can see that the shadows at the claws of the lion are still detected but there are less shadows detected at the mane of the lion.
- Expand the 'Trace' path to see all created 'paths'. Select the 'Point Selection Tool' and select each path one by one. You will see that some of these paths are created inside the lion or in a small shadow part outside the main path. It is safe to delete these paths with context click > 'Delete' (or Delete key).

• This tracing is much better

11. If you want to improve the main path go to the next step. If you are satisfied with this path, select the 'Frame (Through Cut)' path and delete it. 'Apply' the changes in the Product Editor and jump to step 18 ([Create a layout](#)).

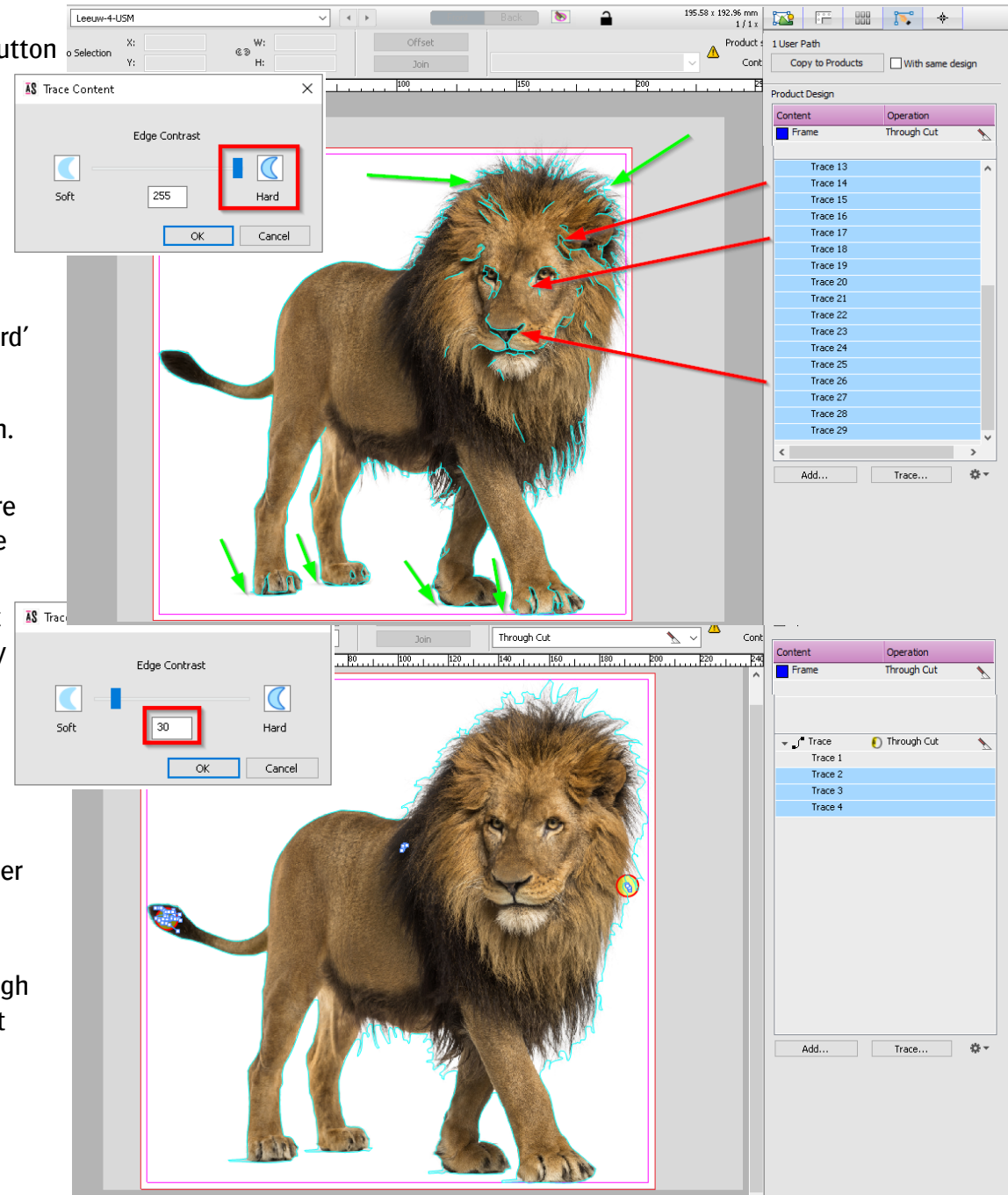

**Improve the main path**

12. Select the 'Trace' path and you can see that it indicates self-intersecting parts. Zoom in to the indication on the image and with the 'Point Selection Tool' select the point and use the handles to change the direction of the Bezier so it doesn't intersect anymore.



13. Zoom out again and repeat this action for all self-intersecting parts, in this case only one extra part.

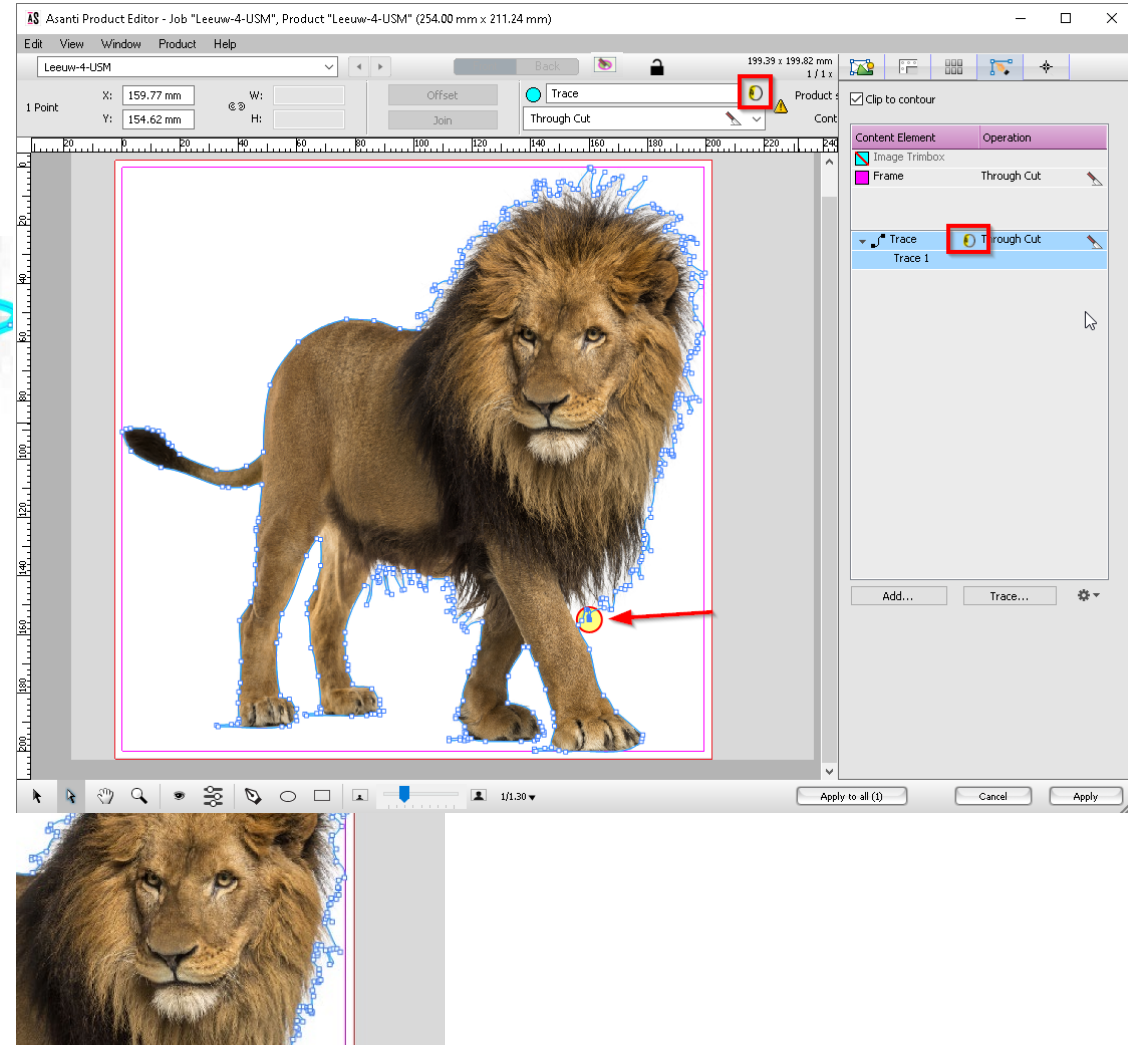
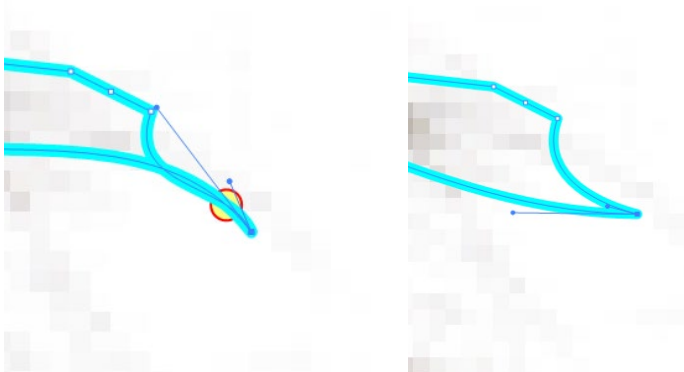

## Tutorial Cut Path Editing

14. Zoom in to one of the shadows of the 'claws of the lion' and with the 'Point Selection Tool' remove all points around the shadow one by one (Select and click the Del-key). It is also possible that you need move a point and use the 'handles' to change the direction of the Bezier that it runs smooth around the claw.

15. You can now see that there is an 'open' 'Trace' path.  
With the 'Pen Tool' you can close it on one end point and then on the other

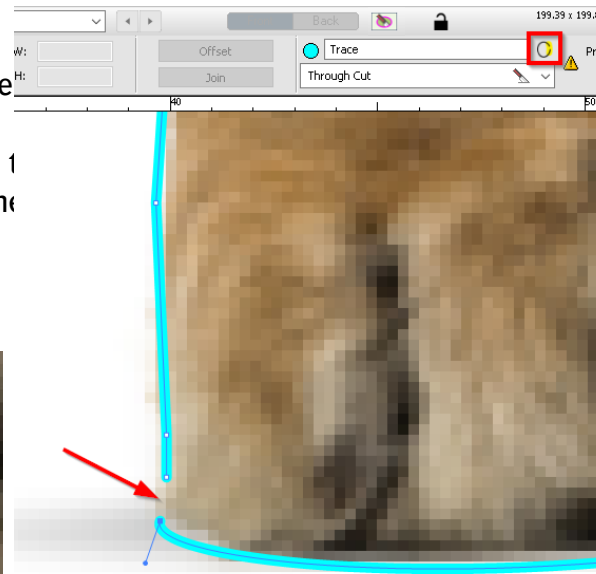
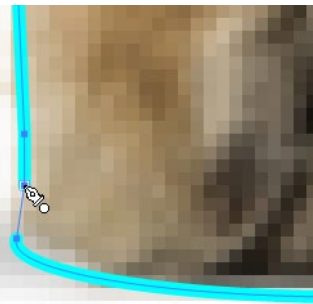

on the other 3 other claws.

17. If you are satisfied with this path, select the 'Frame (Through Cut)' path and delete it. 'Apply' the changes in the Product Editor and go to the next step.  
If you are still not satisfied, you can keep on adjusting the path to your wishes.

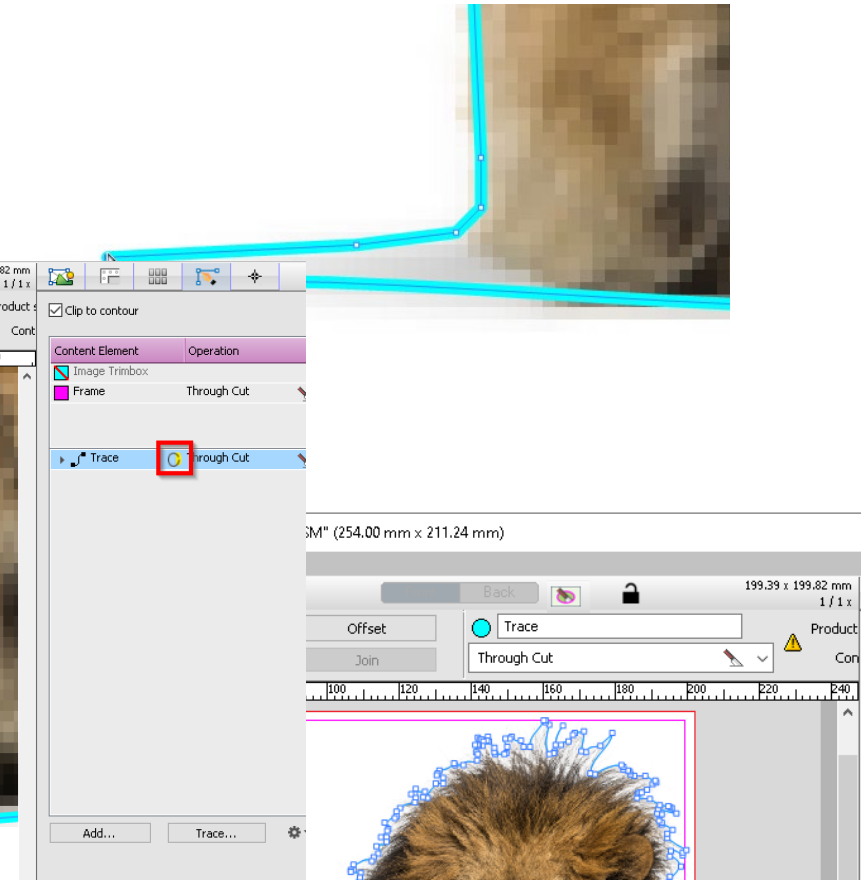
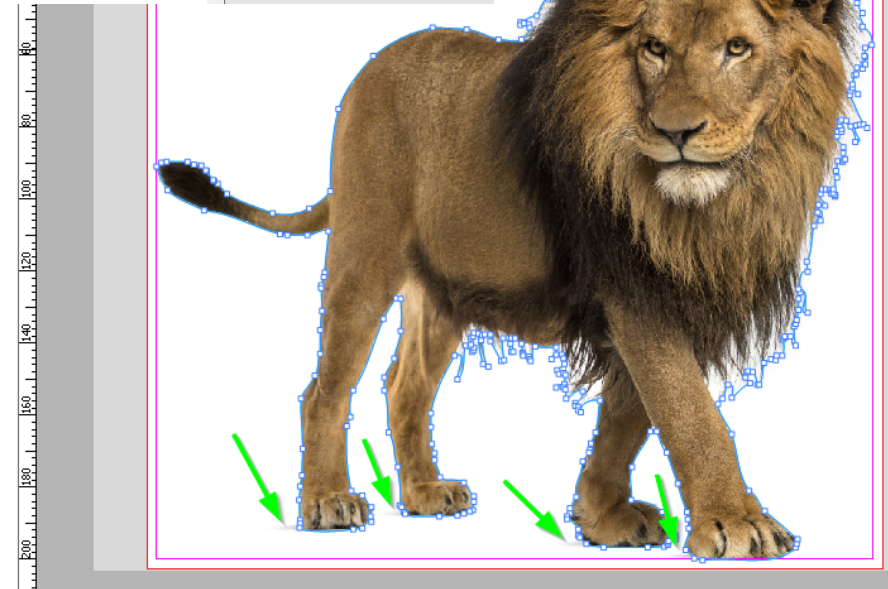



**Create a layout**

18. Select the product and choose 'Sheet > Auto Layout Product' (Ctrl+N).
19. Choose '160 copies', select 'True-Shape Nesting' and optimize the layout for 'Single sheet'.
20. During the 'Auto Layout Progress', click the 'Use' button when the proposed solution has 16 products placed.

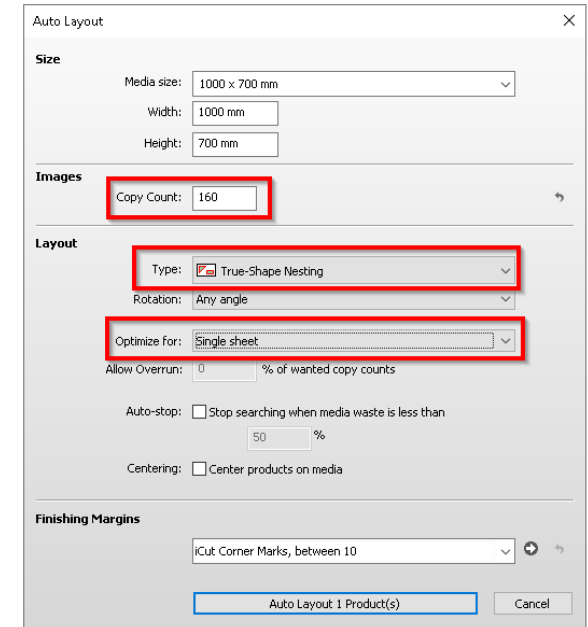
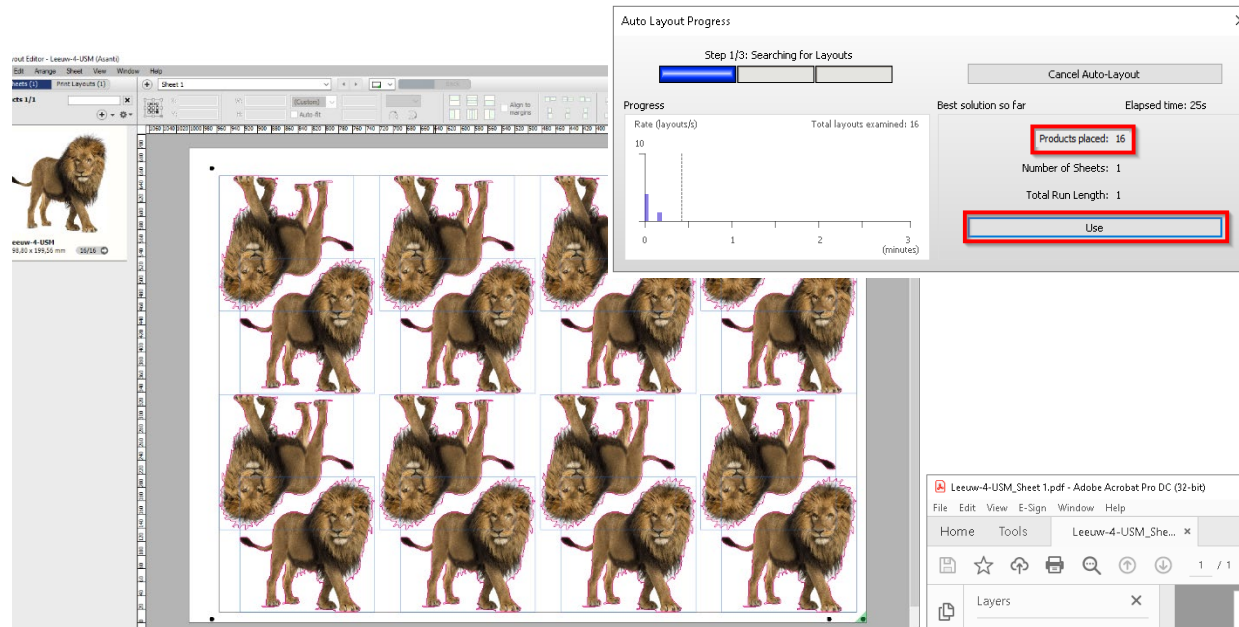

21. Submit Job > Change the job name to 'Create a new contour cut path' > "Make and hold" for Print Files and "Make and send to cutter" for Cut Files.
22. In the job list, context click on the new job and choose 'Reveal Cut File for Job' to open the cut file.

- You can see the new created paths in the correct layer

